



# MSTronic Co., Ltd.

2F, 12, Gongshang Rd., Wugu Township, Taipei County, Taiwan

TEL:886-2-2293-0159 FAX:886-2-2292-8851

E.MAIL: mse@mse.com.tw

WEB: <http://www.mse.com.tw>

## SPECIFICATION

MIT-28G-8024A

PoE Splitter

DC/AC, 1G/5G, 802.3bt, 80W High Power

### 1. INPUT :

1.1 Input Voltage: DC-40V to DC-60V NORMAL= 56V

### 2. OUTPUT :

#### 2.1 Output Voltage & Current & Waveform :

OUTPUT	24Vac	OUTPUT	Waveform
Max. load	3.34A	Category	Square
Power	80W Max	Frequency	60hz±5hz
Min. Load	0A		
Load reg. %	5%		
Line reg. %	1%		

TOTAL POWER : 80W

Note :

(1) For maximum output of 80W, the input DC power supply should be 100W min.

(2) **PoE input must use all 8 pins. If only 4 pins input are used when power draw up to 80W, the connector will be burnt.**

(3) Maximum current 3.75A(90W) for PTZ moving. the input DC power supply should be 120W/56V min.(@ 100m)

3. EFFICIENCY : 85% min @ 56Vin dc

### 4. PROTECTION

#### 4.1 Short Circuit Protection

output Short GND Terminal will not damage the Power Supply and will Auto-Reset. Over Load Protection is flyback mode , auto-recovery.

4.2 Operation frequency Switch is 70KHZ

4.3 Isolation Voltage : 1500Vdc

4.4 Isolation Resistance :100M ohms (min)

4.5 Input Set class Resistance : 25K ohms



# MSTronic Co., Ltd.

2F, 12, Gongshang Rd., Wugu Township, Taipei County, Taiwan

TEL:886-2-2293-0159 FAX:886-2-2292-8851

E.MAIL: mse@mse.com.tw

WEB: http://www.mse.com.tw

4.6 Input Set as an 802.3bt class 8 PD.

4.7 Maximum Load : 150% over load

## LT4294

### APPLICATIONS INFORMATION

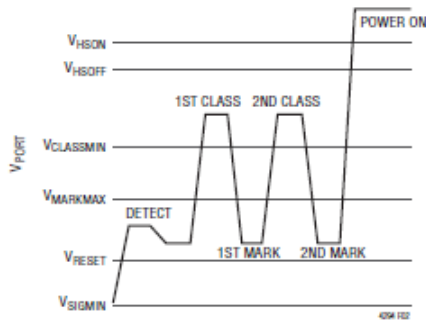

Figure 2. Type 2 PSE, 2-Event Class Sequence

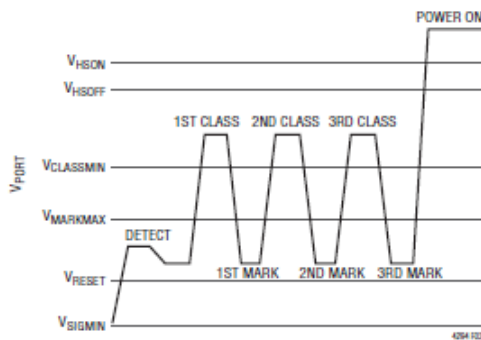

Figure 3. Type 3 or 4 PSE, 3-Event Class Sequence

### IEEE 802.3bt Physical Classification and Demotion

IEEE 802.3bt defines physical classification to allow a PD to request a power allocation from the connected PSE and to allow the PSE to inform the PD of the PSE's available power. Demotion is provided if the PD requested power level is not available at the PSE. If demoted, the PD must operate in a lower power state.

The number of class/mark events issued by the PSE directly indicates the power allocated to the PD and is summarized in Table 1.

IEEE 802.3bt provides nine PD classes and four PD types, as shown in Table 2. The LT4294 class is configured by setting the  $R_{CLS}$  and  $R_{CLS++}$  resistor values.

Table 1. PSE Allocated Class Power

PD REQUESTED CLASS	NUMBER OF PSE CLASS/MARK EVENTS				
	1	2	3	4	5
0	13W				
1	3.84W				
2	6.49W				
3	13W				
4	13W	25.5W			
5	13W	25.5W	40W		
6	13W	25.5W	51W		
7	13W	25.5W	51W	62W	
8	13W	25.5W	51W	71.3W	

Note: Bold indicates the PD has been demoted.

## 5. GENERAL DESCRIPTION

- 5.1 Operation Temperature: -40 - +70 Degree
- 5.2 Storage Temperature: -40 - +85 Degree
- 5.3 Operation Humidity: 5% - 90%
- 5.4 Cooling: Free air cooling
- 5.5 SIZE : 140\*150\*40 (L\*W\*H)m/m



# MSTronic Co., Ltd.

2F, 12, Gongshang Rd., Wugu Township, Taipei County, Taiwan

TEL:886-2-2293-0159 FAX:886-2-2292-8851

E.MAIL: mse@mse.com.tw

WEB: <http://www.mse.com.tw>

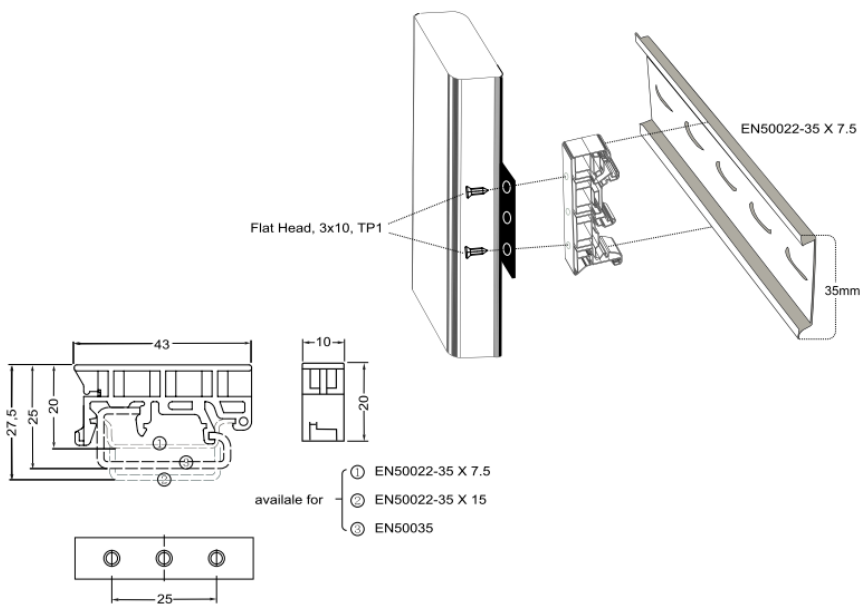
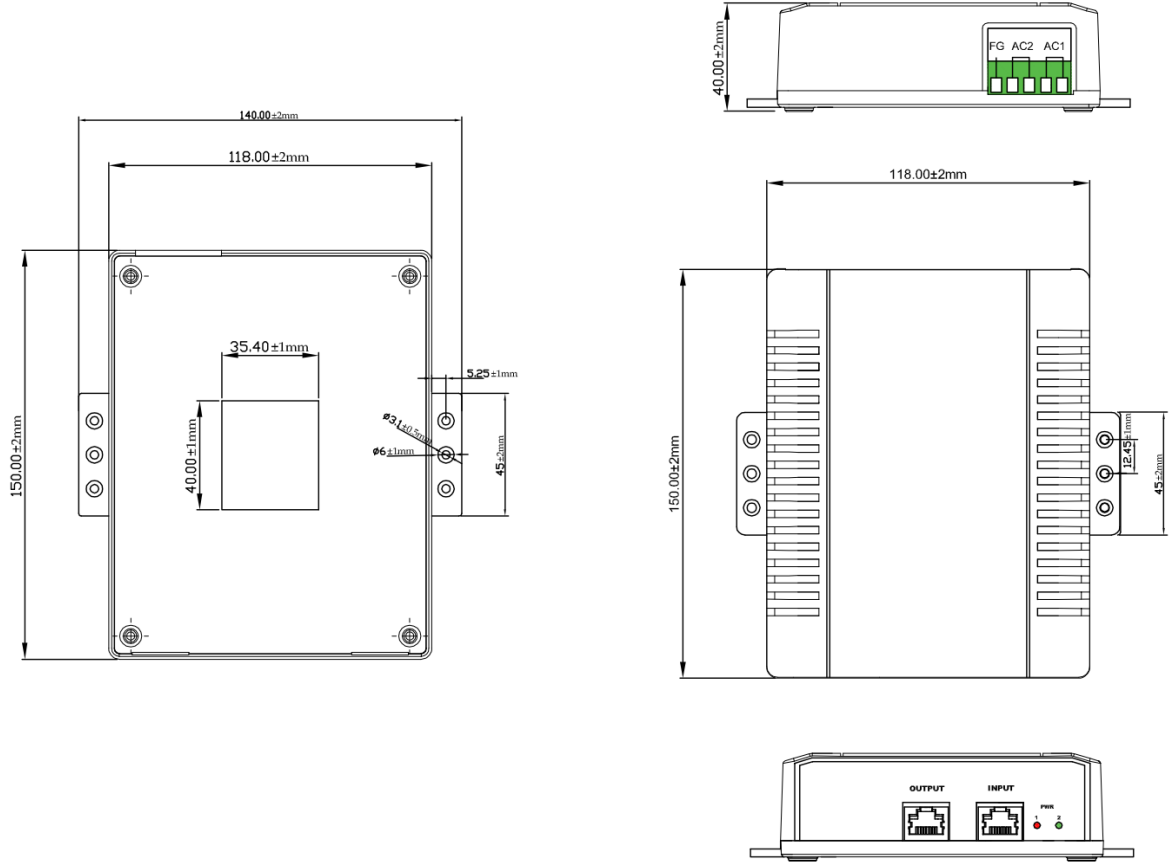

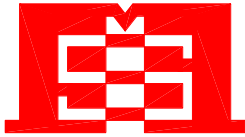

# MSTronic Co., Ltd.

2F, 12, Gongshang Rd., Wugu Township, Taipei County, Taiwan

TEL:886-2-2293-0159 FAX:886-2-2292-8851

E.MAIL: mse@mse.com.tw

WEB: <http://www.mse.com.tw>

## 6. CHANNEL CONNECTORS & PINOUT :

### 6.1 10/100/1000/5000Mbps (5G@CAT6a)

RJ-45 Input (Data & Power)		
Pin	Symbol	Description
1	BI_DA+, Vin A+/-	Data Pair A+, Feeding power A+/-
2	BI_DA-, Vin A+/-	Data Pair A-, Feeding power A+/-
3	BI_DB+, Vin A+/-	Data Pair B+, Feeding power A+/-
4	BI_DC+, Vin B+/-	Data Pair C+, Feeding power B+/-
5	BI_DC-, Vin B+/-	Data Pair C-, Feeding power B+/-
6	BI_DB-, Vin A+/-	Data Pair B-, Feeding power A+/-
7	BI_DD+, Vin B+/-	Data Pair D+, Feeding power B+/-
8	BI_DD-, Vin B+/-	Data Pair D-, Feeding power B+/-
9	Shield	Connector shielding

### 6.2 Output Power & Data -Connected to DTE

RJ-45 Output (only Data)		
Pin	Symbol	Description
1	BI_DA+	Data Pair A+
2	BI_DA-	Data Pair A-
3	BI_DB+	Data Pair B+
4	BI_DC+	Data Pair C+
5	BI_DC-	Data Pair C-
6	BI_DB-	Data Pair B-
7	BI_DD+	Data Pair D+
8	BI_DD-	Data Pair D-
9	Shield	Connector shielding

## 7. EMI

Meet FCC Class A Radiation standard

Meet EN55032 Class A Radiation standard

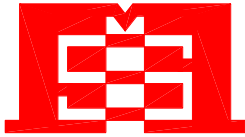

# MSTronic Co., Ltd.

2F, 12, Gongshang Rd., Wugu Township, Taipei County, Taiwan

TEL:886-2-2293-0159 FAX:886-2-2292-8851

E.MAIL: mse@mse.com.tw

WEB: <http://www.mse.com.tw>

## 8. indicators

LED1 for power input, LED2 for AC output

If the input is 802.3at/bt PSE

PoE input on all 4 pairs, LED1 ON, LED2 ON.

PoE input on 2 pairs (data pairs or spare pairs), LED1 flash, LED2 ON

If the input is passive PoE

PoE input on all 4 pairs, LED1 ON, LED2 ON.

PoE input on 2 pairs (data pairs or spare pairs), LED1 flash, LED2 ON

If none input or none in valid voltage input, none LED ON.

## 9. PACKAGE

Brown box (267 x 160x 45mm),

20 pcs/carton , (490x300x370mm) N.W. 7Kg, G.W.: 8Kg, 1.8Cuft.

